

Installation Instructions for Easy Stop™ Roller Shades



Congratulations on
the purchase of your new
Horizons Easy Stop™ Roller Shade!

If your shade was ordered without a valance, please proceed to Step 1.

When your Easy Stop Roller Shade is ordered with a valance it comes from the workroom with the brackets and shade mounted to the valance headrail. Remove the shade from the brackets by pushing forward on the front of the Easy Stop headrail then pulling down on the back of the headrail. Mount the valance with the provided "L" Brackets for Outside Mount or 2" screws for Inside Mount. Then reattach the shade to the brackets using Step 2, Inside Mount instructions.

Step 1: Mount the Brackets

Outside Mount:

Install the appropriate number of wall brackets with the clear tension tab at the bottom of the bracket. This allows for easy removal of the shade.

The brackets should be installed with flat head screws provided.

Care should be taken to ensure all brackets are level.

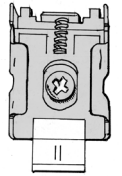

Inside Mount:

Install the appropriate number of brackets with the clear tension tab at the front of the bracket. This allows for easy removal of the shade.

The brackets should be installed with the flat head screws provided.

Care should be taken to ensure all brackets are installed at the same depth.

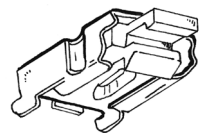

Step 2: Mount the Headrail

Outside Mount:

Place the top of the headrail into the top of the bracket then push the shade forward to snap into the headrail.

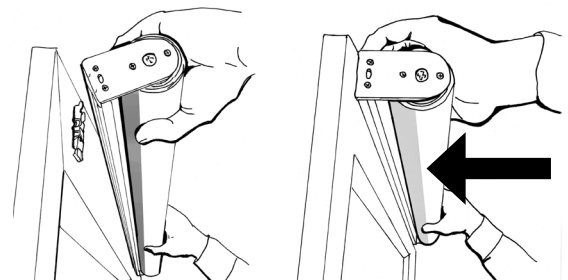

Step 2: Mount the Headrail - Continued

Inside Mount:

Place the rear of the headrail into the rear of the bracket then push the shade up to snap into the headrail.

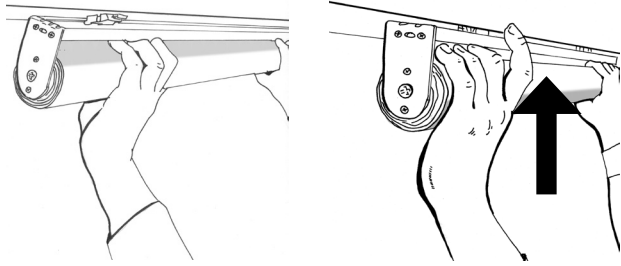

Adjusting Tension

Adjust or set the tension by turning the LEFT Side Adjust bracket clockwise (tighter) with a standard screwdriver. It is recommended to make only $\frac{1}{4}$ to $\frac{1}{2}$ turns until the desired tension is reached.

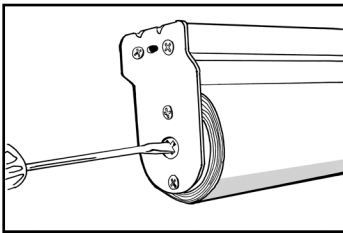

IMPORTANT: Be sure to use a Standard (Flat Head) screwdriver as a Phillips Head can strip the plastic adjustment screw.

Adjusting the Stop

Set the stop device to the desired stop point by using a standard screwdriver on the RIGHT Side Adjust bracket.

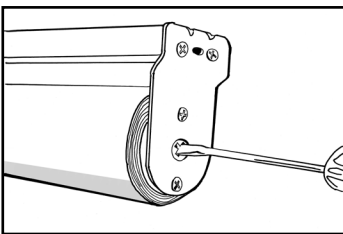

IMPORTANT: Be sure to use a Standard (Flat Head) screwdriver as a Phillips Head can strip the plastic adjustment screw.

Care and Cleaning

We suggest periodic vacuuming with a soft brush attachment. Wet cleaning of any shade is highly discouraged, especially those with cotton content.

Shade Maintenance

Leveling a Crooked Shade

1. Pull down shade until roller is exposed. Do not pull further to avoid pulling cloth off roller.
2. Stick a 5" strip of masking tape into the roller at opposite side from where it is going crooked. Place as close to edge as possible.
3. Roll up shade. If it is still going crooked:
 - A. If shade is still crooked to the same side, add another strip of tape on top of the first one and repeat.
 - B. If shade is crooked to the opposite end, tear off about 1" from tape and repeat

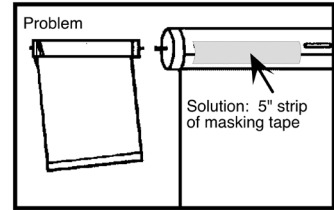

REMEMBER: After making above correction, your hand is still the best guide to rolling a shade straight. Watch the end of the roller as you roll up shade to see if shade is going even.

Wrinkled Shade

We suggest periodic vacuuming with a soft brush attachment. Wet cleaning of any shade is highly discouraged, especially those with cotton content.

Limited Lifetime Guarantee

Horizons Window Fashions warrants that its Horizons products—properly installed in a residential dwelling—will be free from defects in materials and workmanship for as long as the original purchaser owns the product.

All fabric colors tend to lose their original intensity over time, and pull cords eventually wear out. This is considered normal wear and tear and is not covered by this guarantee. Abuse and misuse are not covered. Color lots vary and may not exactly match a previously ordered product. Repair is the purchaser's sole remedy under this guarantee.

This guarantee does not cover incidental or consequential damages, freight, installation, or service calls (trip charges).

HORIZONS™

STYLE THAT MAKES A STATEMENT

www.horizonshades.com